

Exhaust Hose Reel 865

Spring Recoiled



For all types of vehicle workshops, etc. where the hose can hang at a reachable height. The patented spring drive makes the reel very easy to handle. A patented integrated automatic damper saves energy and reduces the noise level. Optional retraction control is available for increased safety and efficiency. Two separate suspension brackets make mounting the reel a simple and safe procedure. The brackets are fixed to the wall or ceiling before the light-weight reel is lifted directly on to the brackets.

It is possible to mount the fan directly on the reel.

- Easy, balanced operation
- Easy and safe installation
- Automatic damper for energy savings
- Easy adjustment of lifting capacity
- Automatic fan on/off switch as option
- Retraction control as option
- Compact, modern design

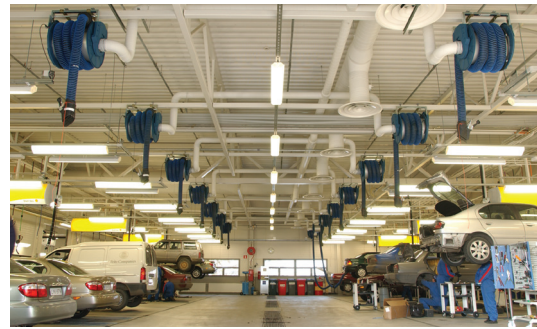

Hose Reels

Hose Ø, mm (in.)	Hose type*	Hose length, m (ft) included	Max possible hose length, m (ft)**	Type of body	Automatic damper	Spring type***	Reel with hose Part no.	Reel without hose Part no.
75 (3)	NTP	5.0 (16)	7.5 (24)	short		S	20800865	
75 (3)	NR-CP	5.0 (16)	7.5 (24)	short	X	S	20801465	
75 (3)	-	-	7.5 (24)	short	X	S		20800965
100 (4)	NTP	5.0 (16)	7.5 (24)	short		S	20810265	
100 (4)	NR-CP	5.0 (16)	7.5 (24)	short	X	S	20800665	
100 (4)	NTP	7.5 (24)	10.0 (33)	wide		M	20810365	
100 (4)	NR-CP	7.5 (24)	7.5 (24)	short	X	M	20805365	
100 (4)	NR-CP	10.0 (33)	10.0 (33)	wide	X	M	20801965	
100 (4)	-	-	7.5 (24)	short		S		20804365
100 (4)	-	-	10.0 (33)	wide		M		20804665
100 (4)	-	-	7.5 (24)	short	X	M		20800765
100 (4)	-	-	10.0 (33)	wide	X	M		20800365
125 (5)	NTP	5.0 (16)	5.0 (16)	short		S	20800465	
125 (5)	NR-CP	5.0 (16)	5.0 (16)	short	X	S	20801165	
125 (5)	NTP	7.5 (24)	10.0 (33)	wide		M	20801765	
125 (5)	NR-CP	7.5 (24)	10.0 (33)	wide	X	M	20802065	
125 (5)	NR-CP	10.0 (33)	10.0 (33)	wide	X	M	20802165	
125 (5)	-	-	10.0 (33)	wide		M		20804765
125 (5)	-	-	10.0 (33)	wide	X	M		20800165
150 (6)	NR-CP	5.0 (16)	5.0 (16)	short	X	L	20801065	
150 (6)	NR-CP	7.5 (24)	10.0 (33)	wide	X	L	20802265	
150 (6)	NR-CP	10.0 (33)	10.0 (33)	wide	X	L	20802365	
150 (6)	-	-	5.0 (16)	short		L		20804565
150 (6)	-	-	10.0 (33)	wide		L		20804865
150 (6)	-	-	5.0 (16)	short	X	L		20804165
150 (6)	-	-	10.0 (33)	wide	X	L		20804265

* Hose type - see separate section

** Selection of additional hoses: see separate hose section

*** S = Small, M = Medium, L = Large

Pressure drop diagram

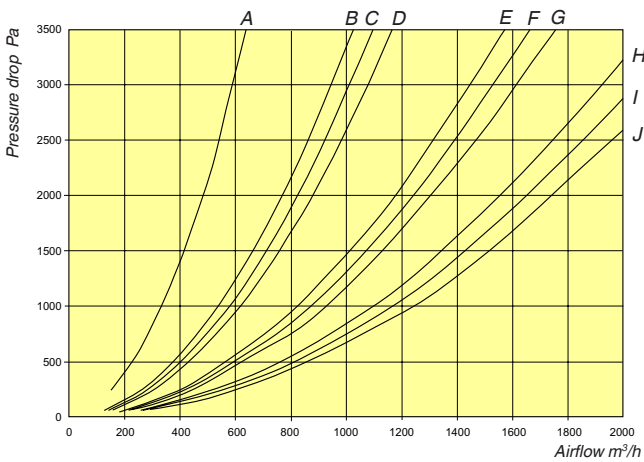

- A. 75 mm (3"), 5 m (16')
- B. 100 mm (4"), 10 m (33')
- C. 100 mm (4"), 7.5 m (25')
- D. 100 mm (4"), 5 m (16')
- E. 125 mm (5"), 10 m (33')
- F. 125 mm (5"), 7.5 m (25')
- G. 125 mm (5"), 5 m (16')
- H. 150 mm (6"), 10 m (33')
- I. 150 mm (6"), 7.5 m (25')
- J. 150 mm (6"), 5 m (16')

For exhaust extraction systems in vehicle repair shops where engines are running without load and with low rpm's, the following air flows can be used as guidelines: Cars = 400 m³/h (110 l/s; 250 cfm) Trucks = 1000 m³/h (280 l/s; 600 cfm) (pressure drop over reel when most of the hose is uncoiled)

Dimensions

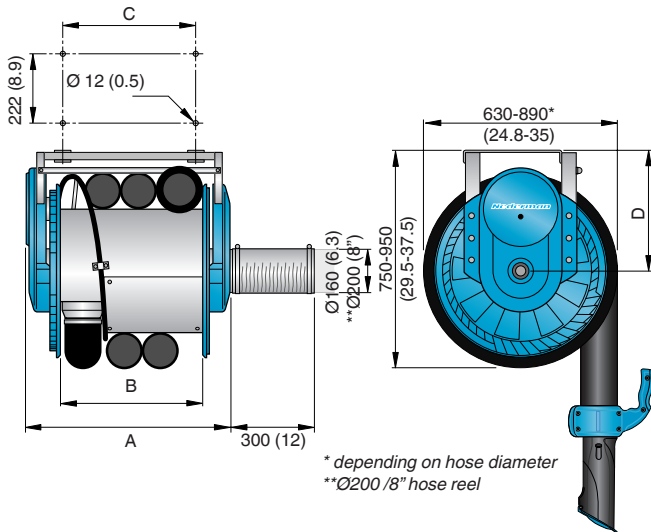

* depending on hose diameter
 ** Ø200 / 8" hose reel

	Short drum	Wide drum 4-6"	Wide drum 8"
A	725 (28.5)	1055 (41.5)	1155 (45.5)
B	500 (19.7)	830 (32.7)	830 (32.7)
C	370 (14.6)	700 (27.6)	700 (27.6)
D	435 (17.1)	435 (17.1)	495 (19.5)

Installation

- On ceiling or wall
- Maximum mounting height is 6 m

Technical Data

- Ambient temperature**
 - -10°C to +50°C
- Bracket**
 - Galvanized steel
 - Separate
 - Simplifies installation
- Colour**
 - Blue, RAL 5009
 - Zinc or aluzinc-plated (metal parts)
- Connection hose**
 - Polyester/aluminium
 - Connects to duct system, Ø160 mm
- Damper**
 - Mechanical
 - Operated by drum rotation
- Drum cylinder**
 - Aluminium/zinc plated steel sheet
- Drum end**
 - Composite; 30 % glass
 - Integrated sprockets for spring gear and ratchet
- Drum shaft**
 - Composite; 30 % glass
 - With ball bearing
- Duct connection**
 - Ø160 mm
 - Max. exhaust temperature: 300°C
- Frame side**
 - Composite; 30 % glass
 - Integrated spring unit
- Framework**
 - Zinc plated square steel tube
- Hose adapter**
 - Cast aluminium
 - Connects hose to internal duct
- Hose guide**
 - Aligns hose on the drum
- Hose stop collar**
 - Makes nozzle stop at a fixed height
- Internal duct**
 - Rolled, aluminium plated steel band
 - Highly corrosion resistant
- Ratchet mechanism**
 - Locks uncoiled hose in position
- Safety lock**
 - Locks drum during hose replacement or check-ups
- Spring unit**
 - Power transmission via gear with ball bearings
 - Tension adjustment from the outside
- Weight**
 - Short body, without hose: 23 kg
 - Short body, with hose: 31-38 kg (depending on hose type, length, and diameter)
 - Wide body, without hose: 31 kg
 - Wide body, with hose: 41-49 kg (depending on hose type, length, and diameter)
- Installation**
 - On ceiling or wall
 - Maximum mounting height: 6 m
 - Designed for indoor installations, but can be installed outdoors in protected areas (the metal components are protected against corrosion).
- Maintenance**
 - No maintenance required when reel is exposed to normal wear. Cleaning of exterior and regular check-ups according to instruction manual should be done.

Environmental data

Sound	The product excluding fan does not generate any sound
Recycling level	100%
Energy consumption	The product excluding fan does not consume any energy

Nederman automatic damper

A patented function operated by drum rotation. When the hose is pulled out, the damper opens for the airflow. When the hose starts to recoil, the damper stops the airflow. This leads to reduced sound level, more efficient utilisation of the fan capacity, and less extraction of heated (or cooled air).

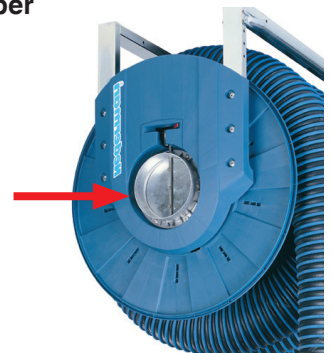

Accessories

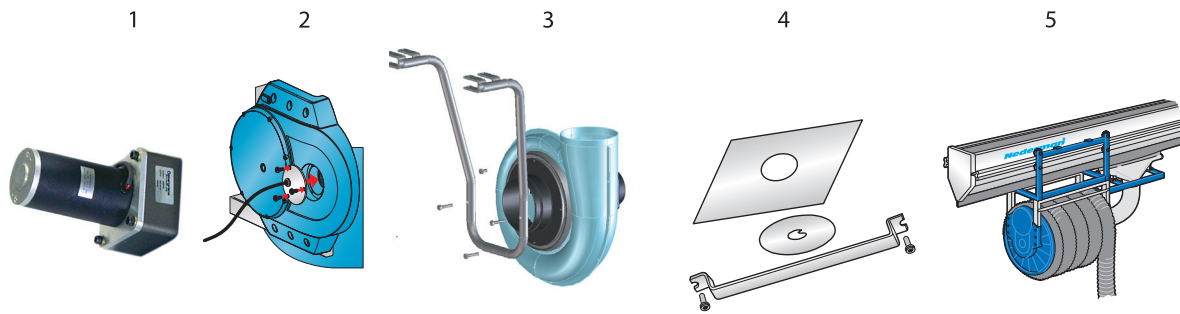

	Description	Part no.
1	Retraction control kit	20373880
2	On/off switch	20373557
3	Fan bracket	20373556
	Transformer for fan controls 230/24V, 75VA, 50 Hz	10361560
	Transformer for fan controls 230/24V, 25VA, 50 Hz	10363189
	Spring 25 x 1.0 x 10000 mm	20373592
	Spring 25 x 1.1 x 15000 mm	20373593
	Spring 40 x 1.0 x 18000 mm	20373594
4	Upgrade-kit for double springs (excluding springs).	20374111
5	Extraction trolley Reel on Rail, for spring recoiled reel used in combination with rail ALU 150. For further information, please contact your nearest Nederman dealer.	20948610

Retraction control (optional)

- A patented solution for controlling the recoiling of the hose on Exhaust Hose Reel.
- The Retraction Control is a safety feature. It acts as a brake making the hose recoil in a low and steady pace.
- The Retraction Control eliminates the risk of damages by swinging nozzle.
- The Retraction Control does not require any external power supply.

